



## APARTMENT 32, MASTER WILLIAMS PLACE FOLKESTONE, CT20 1FF

**£1,495 PER MONTH**

Welcome to this exquisite penthouse apartment located in the desirable Master William's Place, Folkestone. This newly built property, completed in 2026, offers a modern living experience with a generous space of 851 square feet.

As you enter, you will be greeted by a bright and airy reception room that serves as the heart of the home, perfect for both relaxation and entertaining. The apartment features two well-proportioned bedrooms, providing ample space for rest and privacy. With two stylish bathrooms, convenience is at your fingertips, ensuring that morning routines and evening unwinding are both effortless and enjoyable.

For those who require parking, underground parking is available at the building, subject to a separate agreement for a monthly fee. Additionally, parking on the high street is permitted from 6pm to

**WEST END  
ESTATES**  
LETTINGS AND PROPERTY MANAGEMENT

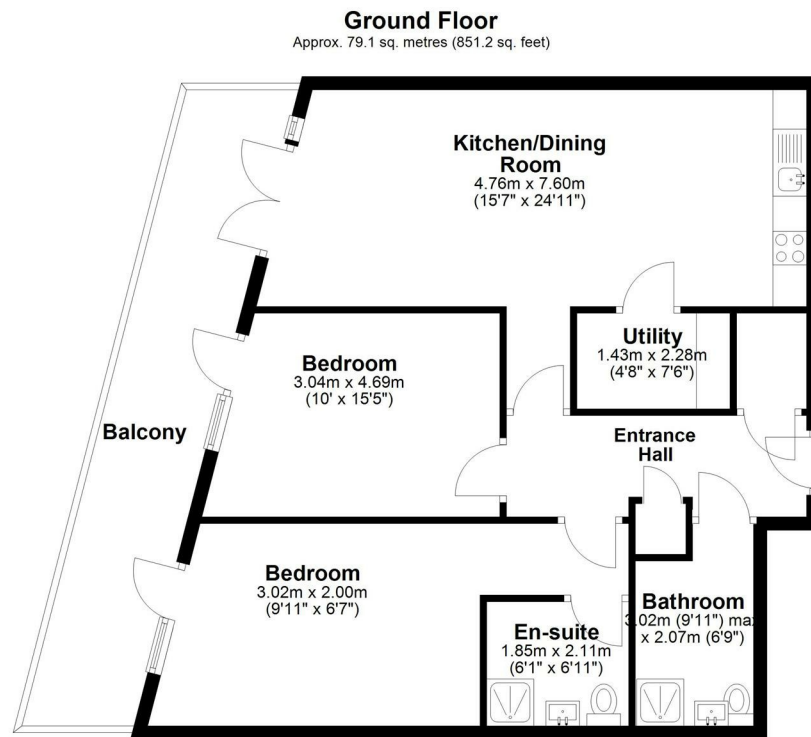

Total area: approx. 79.1 sq. metres (851.2 sq. feet)

Whilst every attempt has been made to ensure the accuracy of the floorplan contained here, measurements of doors, windows, rooms and any other items are approximate and no responsibility is taken for any error, omission or mis-statement. This plan is for illustrative purposes only and should be used as such by any prospective purchaser. The services, systems and appliances shown have not been tested and no guarantee as to their operability or efficiency can be given.  
Plan produced using PlanUp.



Energy Efficiency Rating		
	Current	Potential
Very energy efficient - lower running costs		
(92 plus) <b>A</b>		
(81-91) <b>B</b>	<b>88</b>	
(69-80) <b>C</b>		
(55-68) <b>D</b>		
(39-54) <b>E</b>		
(21-38) <b>F</b>		
(1-20) <b>G</b>		
Not energy efficient - higher running costs		
<b>England &amp; Wales</b>	EU Directive 2002/91/EC	

**EPC Rating: B    Council Tax Band: B**

Agents Note: Whilst every care has been taken to prepare these particulars, they are for guidance purposes only. All measurements are approximate and are for general guidance purposes only and whilst every care has been taken to ensure their accuracy, they should not be relied upon and potential buyers/tenants are advised to recheck the measurements

West End Estates Folkestone  
7 Sapper Row  
Folkestone  
Kent  
CT20 3WT

01303 478777  
office@westend-estates.co.uk

**WEST END  
ESTATES**  
LETTINGS AND PROPERTY MANAGEMENT